

The BPFC026 Series is a kind of Y type ball clevis, and it used for insulators, suspension clamp or protection fittings connected to other suspension or tension string set of fittings. It is made of malleable iron or casting steel and hot-dip galvanized. Cotter pins are stainless steel, the other parts are hot-dip galvanized steel.

Mechanical Dimension (mm)

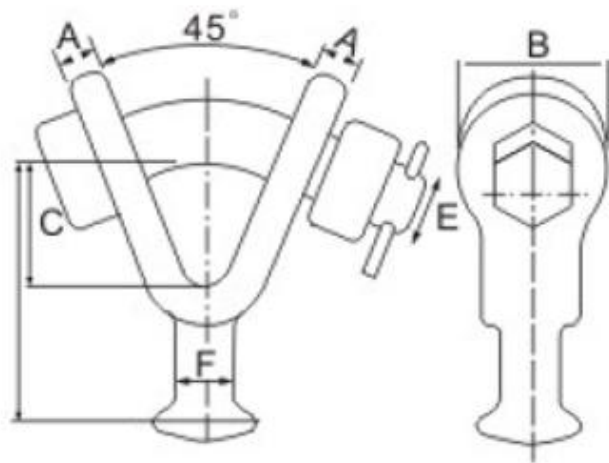

Model	Dimension(mm)						Rated Failure Load(kN)	Weight (kg)
	A	B	C	D	E	F		
BPFC026-30	12	45	38	80	20	16	30	0.8
BPFC026-50	14	55	60	100	22	22	50	1.2